

Issued by Canon (UK) Limited

Model:**Additional Finisher Tray-A1****Ref No.:**Acc-397
(F3-T01-00W-10027-01)**Date:**25-06-04

Location:

OPTION TRAY ASSEMBLY

Subject:

Preventing additional finisher tray from being detached

Detail:

<Symptom>

The additional finisher tray is detached/The error code E540 is indicated

<Cause>

The additional finisher tray lifts the slide guide when coming up. At this time the slide guide inclines, and is warped toward the direction A (see the photo below) together with the upper height panel. Due to this, the additional finisher tray comes free from the L-shape rim of the slide guide and gets on the rim.

As a result, the additional finisher tray bumps into the slide guide when coming down, leading to detachment of the additional finisher tray or the error code E540-0001 (upper tray ascent/descent motor clock error).

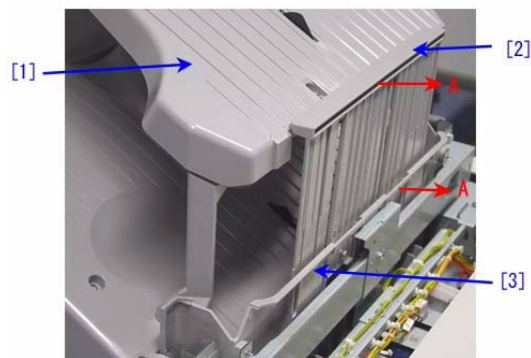

F-1

[1] Additional Finisher Tray

[2] Slide Guide

[3] Upper Height Panel

<Factory Measures>

The slide guide stopper to prevent the upper height panel from being warped is included with the additional finisher tray A1 product.

(Attach the slide guide stopper when installing the additional finisher tray A1.)

Service Work:

Attach the slide guide stopper to the finisher frame when either of the foregoing symptoms occurs. For attaching procedure, see the attached file "Slide Guid Stopper Installation Procedure".

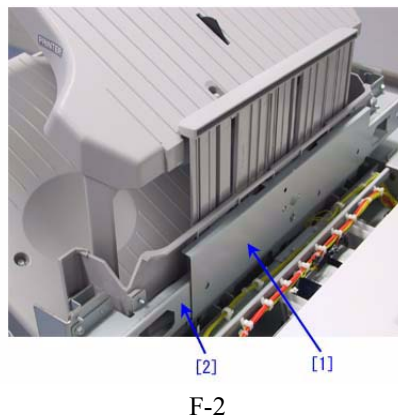

[1] Slide Guide Stopper

[2] Finisher Frame

Service Parts:

	Description	Part Number	Q'ty	I.C.	P.C.
Old					
New	Stopper, Guide, Slide	FC5-6994-000	0->1		Q17

Affected Machines:

JLE01606 and later

Slide Guid Stopper Installation Procedure

1) In the case of the Finisher-Q1/R1, open the front door [1], remove the 3 screws [2], and detach the front cover [3].

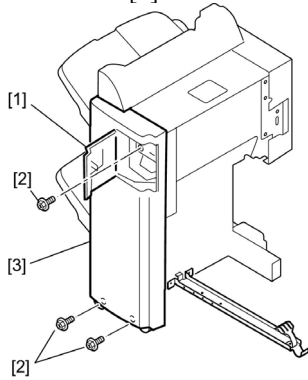

2) In the case of the Saddle Finisher-Q2/R2, open the front cover [1].

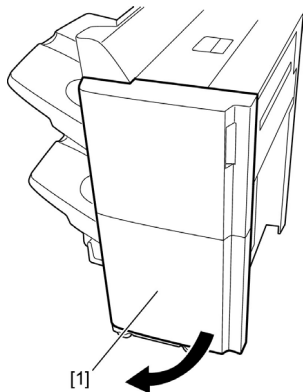

3) In the case of the Finisher-Q1/R1, remove the 3 screws [1], and detach the rear cover [2].

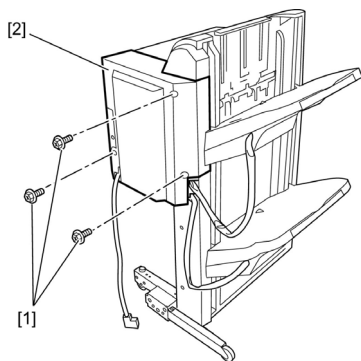

4) In the case of the Saddle Finisher-Q2/R2, detach the cable cover [1], remove the 6 screws [2], and detach the rear cover [3].

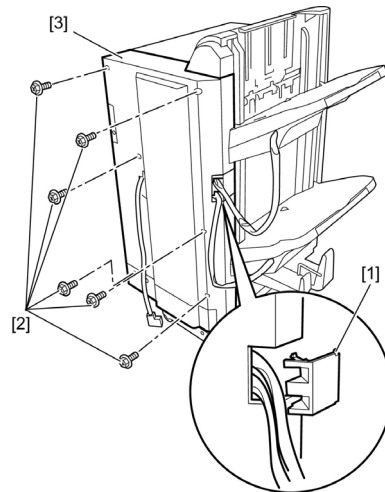

5) Remove the 2 screws [1], and open the upper cover of the finisher; then, detach the upper left cover [3] as if to pull out the claw [2].

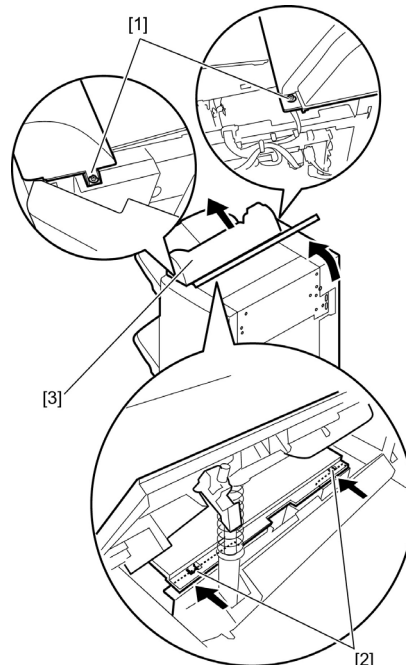

6) Remove the screw [1], and detach the slide guide stopper [2]; then, slide the slide guide [3] upward to detach. The removed slide guide stopper will not be used later.

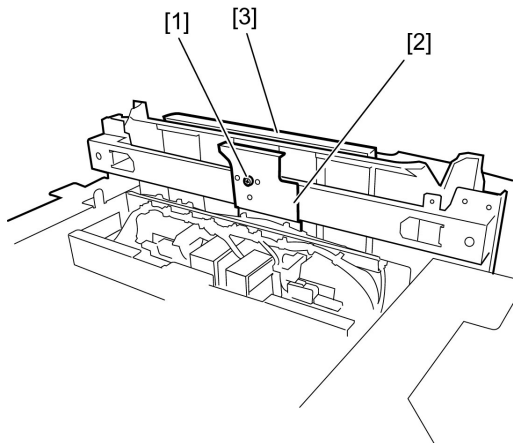

7) Before mounting the slide guide, which is contained in the carton box, on the finisher, place the lubricant (permanent lubricant G2) [1] at five points on the slide guide and spread it over the slide guide. (The locations for lubricant application are indicated in [2] in the slide guide.)

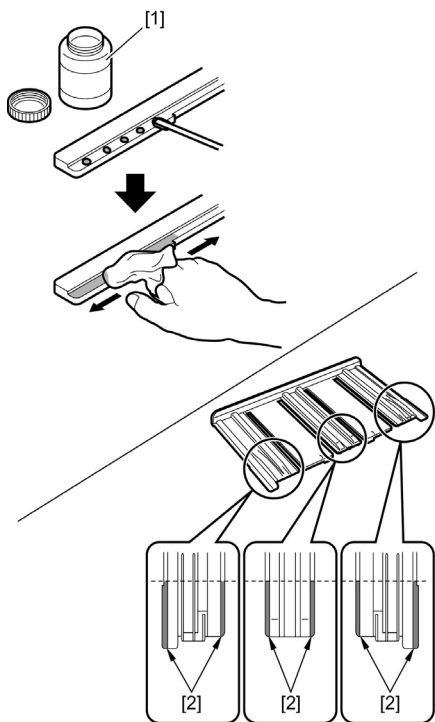

8) Wipe off the extra lubricant with lint-free paper, so that only a slight amount of lubricant is left on the surface.

! If you fail to completely wipe off the extra lubricant, it may adhere to copy paper.

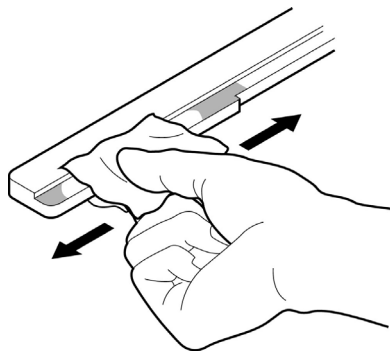

9) Slide-in the slide guide from top to the finisher.

10) Peel off the liner from the double-faced tape [2] adhered to the supplied slide guide stopper [1] at two positions.

11) Using the screw (RS tight, M3 x 8) [3] removed in step 6, install the slide guide stopper.

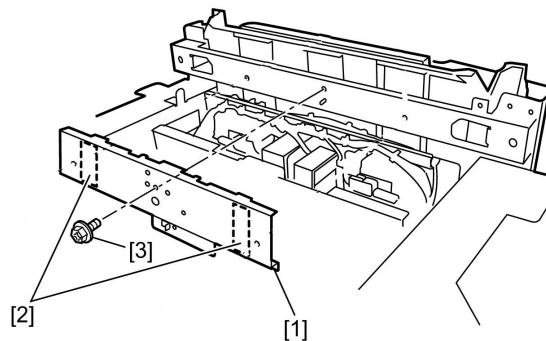

12) Mount the upper left cover, rear cover, and front cover (in the case of the Finisher-Q1/R1) of the finisher.